

Restrict content on an iPad/Tablet computer

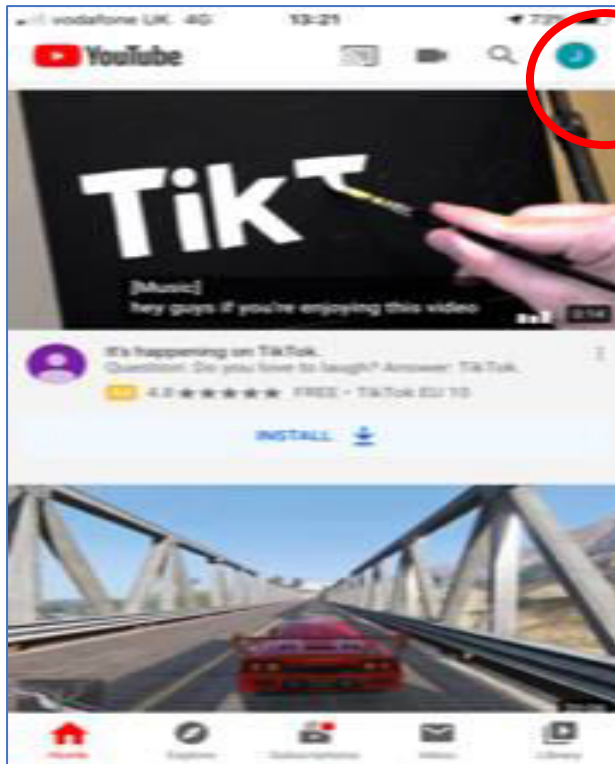

NOTE: If there is no letter it will probably say sign in. They should not be able to access restricted content unless it is signed in, which is fine for most children.

However, some children create their own accounts so the following steps need to be taken:

1. On YouTube go to the letter in the top right corner.

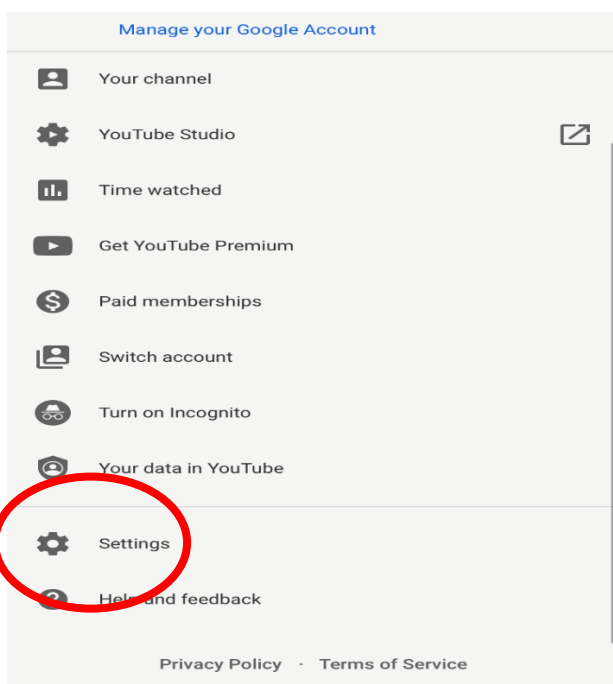

2. Go to the cog/setting tab

Settings

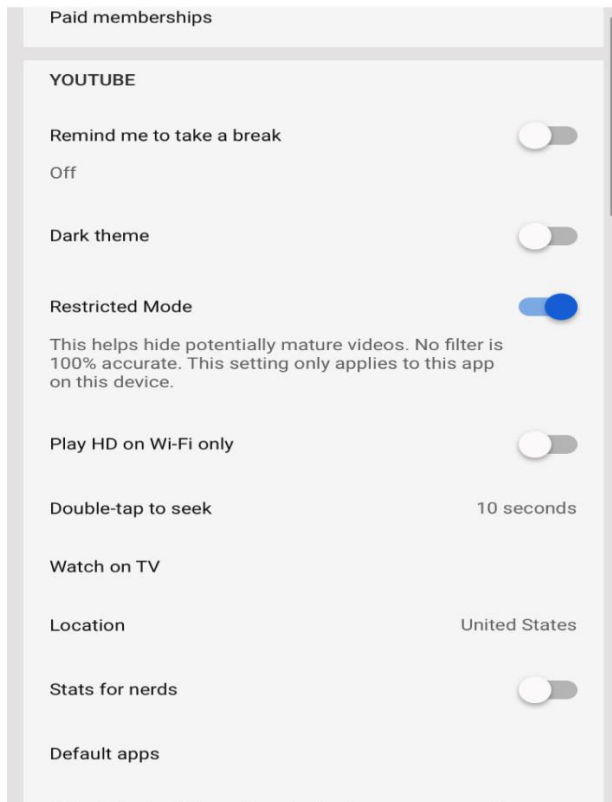

3. On the restricted Mode ensure that the tick is coloured blue. This means it is on.

NOTE: Please note that the children should be accessing the iPad with adult supervision. If they know how, they can go into the settings and turn it off.

Parents will also need to ensure this is on before giving children the computer.